

First Floor Tenant Build-out Plan

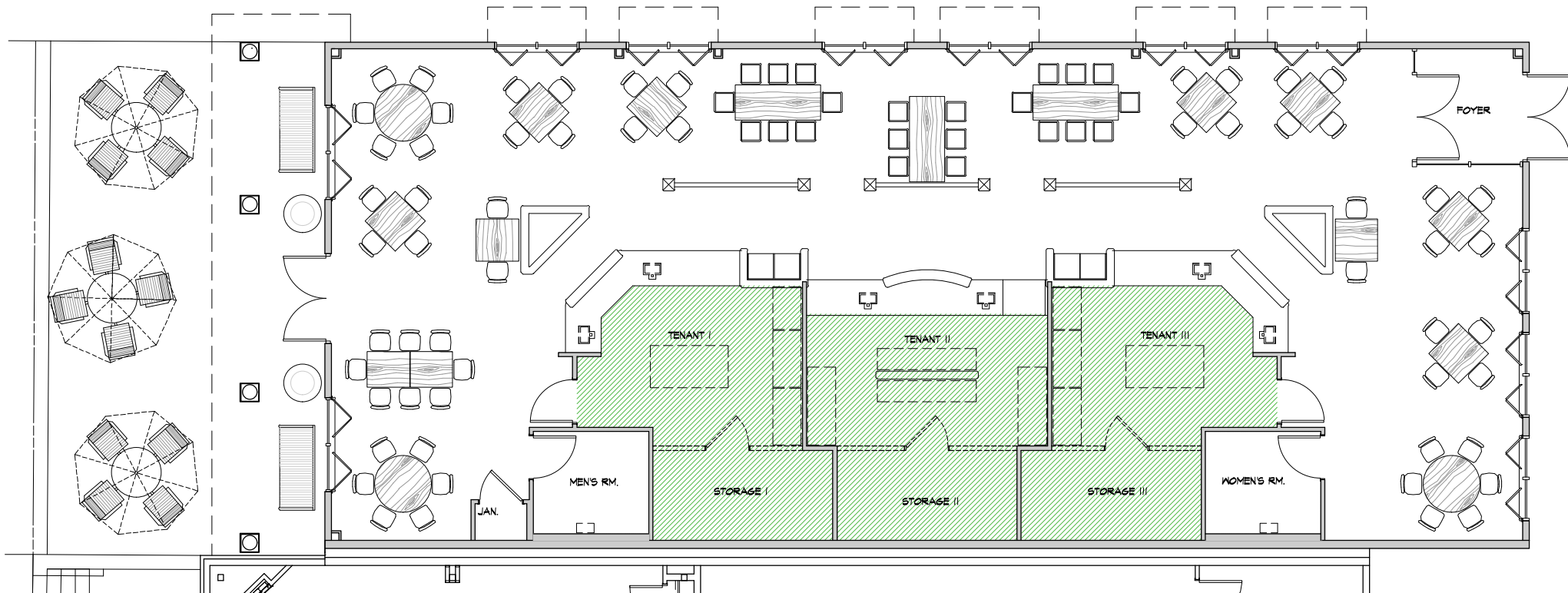

ROCHESTER, NEW YORK 14615

BUILDING 'A' FOOD COURT

COLOR KEY:

 TENANT BUILD-OUT AREA

SQUARE FOOTAGES (INTERIOR)

OVERALL TENANT SPACE..... 749 SQ. FT.
 OVERALL COMMON AREA SPACE..... 2,183 SQ. FT.
 TOTAL INTERIOR SQUARE FOOTAGE..... 2,932 SQ. FT.

[illegible]

BUILDING 'A' FOOD COURT

GENERAL COUNTERTOP NOTE:

- ALL SOLID SURFACES TO HAVE ROUNDED/ EASED EDGES; REFER TO FINISH PLAN/ SCHEDULE FOR PRODUCT SELECTIONS, TYP.
- SOLID SURFACE THICKNESSES AS INDICATED PER MATERIAL SELECTION SPECIFIED, TYP.



* ALL INTERIOR FIXTURE FINISHES TO BE COLOR 'WHITE', TYP.
* INTERIOR FIXTURE SELECTIONS & CUTSHEETS SUPPLIED TO CONTRACTOR BY ARCHITECT, TYP.

Food Court Partial Interior Elevation

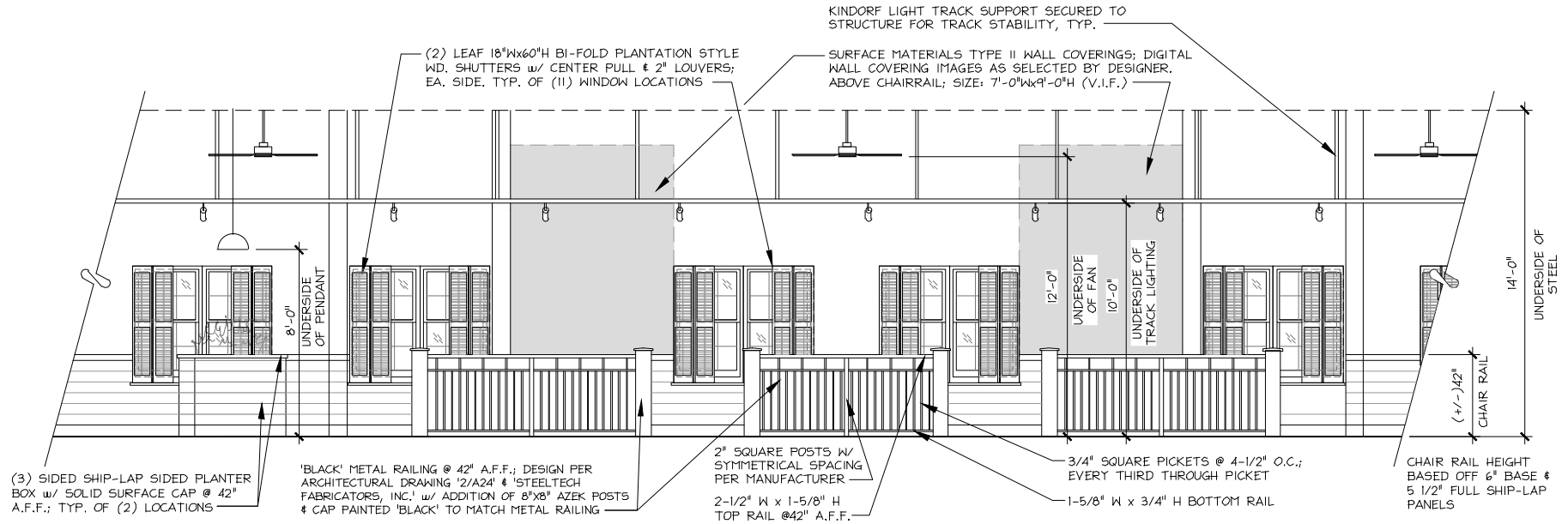

GENERAL NOTES:

*THIS DRAWING IS DONE FOR COST PURPOSES ONLY AND DEPENDENT ON ALL FINAL MATERIAL SELECTIONS, HEIGHTS, AND QUANTITIES.

ROCHESTER, NEW YORK 14615

BUILDING 'A' FOOD COURT

INCLUDED IN BASE CONTRACT:

1A' 4" RECESSED CAN FIXTURE..... 7 QTY.
1D' EXT. SURFACE POINTED FIXTURE..... 2 QTY.
1E1' EMERGENCY FIXTURE..... 3 QTY.
1X' EXT. LIGHTING..... 3 QTY.
REFER TO ELECTRICAL DRAWING 'E22' TYPICAL.

PROPOSED CEILING ITEMS

CEILING TILES
242 SCRUBBABLE VINYL CEILING TILES (INCLUDING LIGHTS)..... (4'-7)774 S.F.
LIGHTS
1B' 242 BATHROOM TROFFERS..... 2 QTY.
1W' 242 KITCHEN TROFFERS..... 2 QTY.
1A' 4" RECESSED CAN FIXTURE..... 22 QTY.
1" TRACK HEAD..... 34 QTY.
TRACK (MOUNTED 12'-0" A.F.F.)..... 10 TOTAL LINEAR FT.
1/4" DIA. PENDANT LIGHTS (MOUNTED 8'-0" A.F.F.)..... 2 QTY.
6" DIA. CEILING FANS (MOUNTED 12'-0" A.F.F.)..... 2 QTY.
EXHAUST FAN..... 1 QTY.
1A' 24" SURFACE POINTED FIXTURE..... 2 QTY.

GENERAL FIXTURE NOTE:

* ALL INTERIOR FIXTURE FINISHES TO BE COLOR 'WHITE', TYP.
* INTERIOR FIXTURE SELECTIONS & CUTSHEETS SUPPLIED TO CONTRACTOR BY ARCHITECT, TYP.

Food Court Finish & Furniture Floor Plan

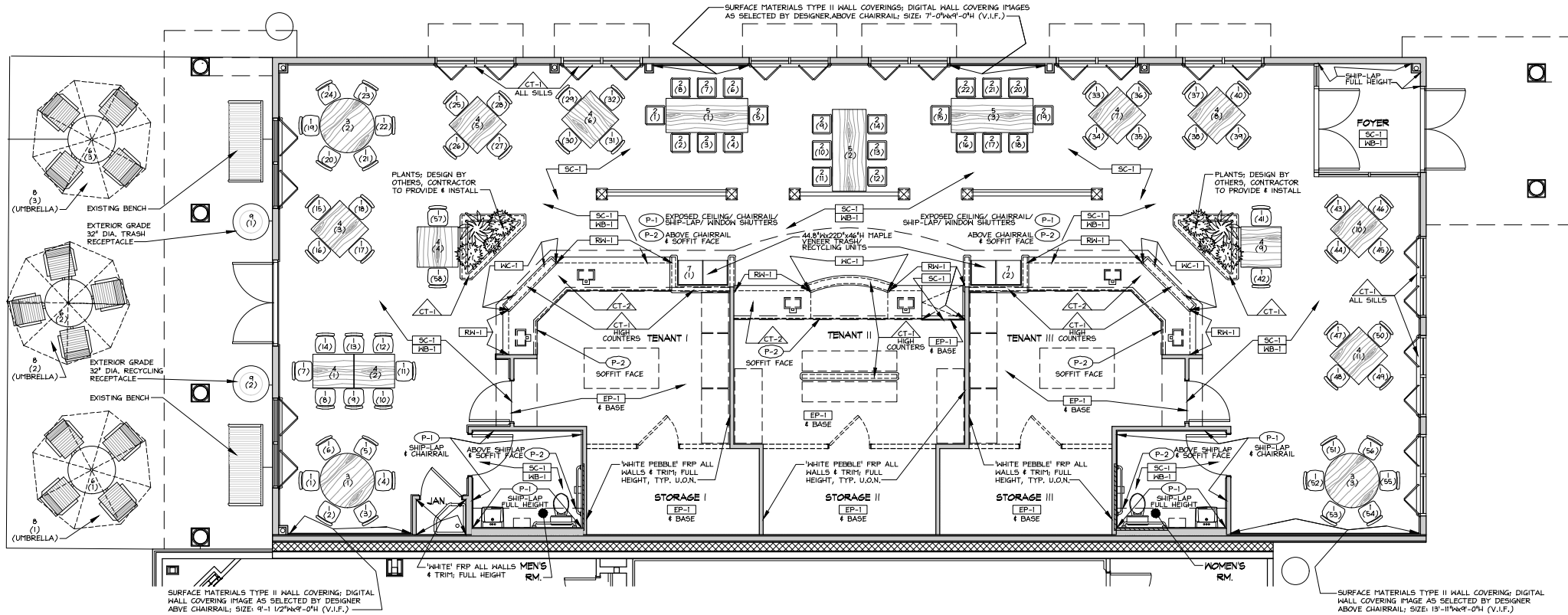

ROCHESTER, NEW YORK 14615

BUILDING 'A' FOOD COURT

FINISH GENERAL NOTES

- * MATERIAL TAKE OFFS ARE TO BE TAKEN FROM FIELD MEASUREMENTS. CONTRACTOR IS RESPONSIBLE FOR VERIFICATION OF QUANTITIES PRIOR TO PLACING ANY ORDER.
- * ALL WINDOW TREATMENTS AS SPECIFIED TO BE PROVIDED AND INSTALLED BY GC.
- * ALL SPECIFIED AREAS TO RECEIVE PAINT MUST BE PREPARED TO RECEIVE ENOUGH COVERAGE.
- * PAINT ALL UNDERSIDES OF SOFFITS P-1 U.O.N.
- * PREP AND PAINT ALL CEILINGS, SOFFITS AND ITS UNDERSIDE USING FLAT BASE IN THE P-1 COLOR SPECIFIED.
- * PREP AND PAINT ALL DOOR FRAMES USING SEMI-GLOSS BASE IN THE P-2 COLOR SELECTED.
- * PREP AND PAINT ALL WALLS USING A SATIN BASE IN THE COLOR P-2 SPECIFIED, U.O.N.
- * PAINT ALL TRIM P-1 IN SEMI-GLOSS BASE.